

**S Sandberg®**  
**ACTIVE**

# Survivor Powerbank 8in1 96000

Quick guide

420-78



[www.sandberg.world](http://www.sandberg.world)

## Overview

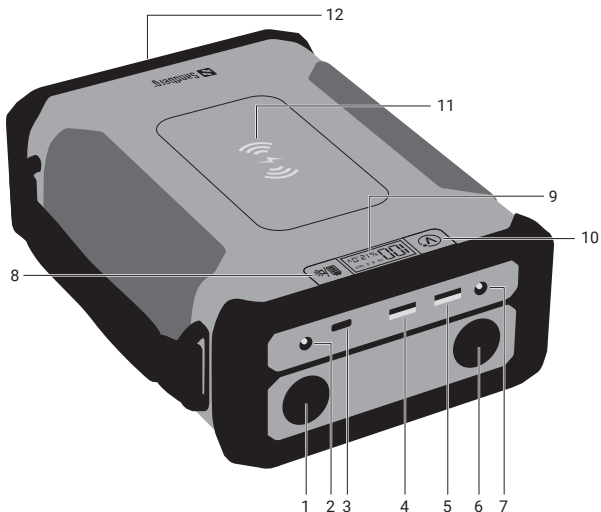

1. 12V Car Lighter Output Socket
2. DC Input (Can't work simultaneously with USB-C port)
3. USB-C Input/Output
4. USB-A 2 Output
5. USB-A 1 Output
6. 12V Car Lighter Output Socket

7. DC Output
8. Power button
9. LED Display
10. DC Out voltage set button
11. Wireless charging area
12. Flashlight and emergency light

## Detailed specification

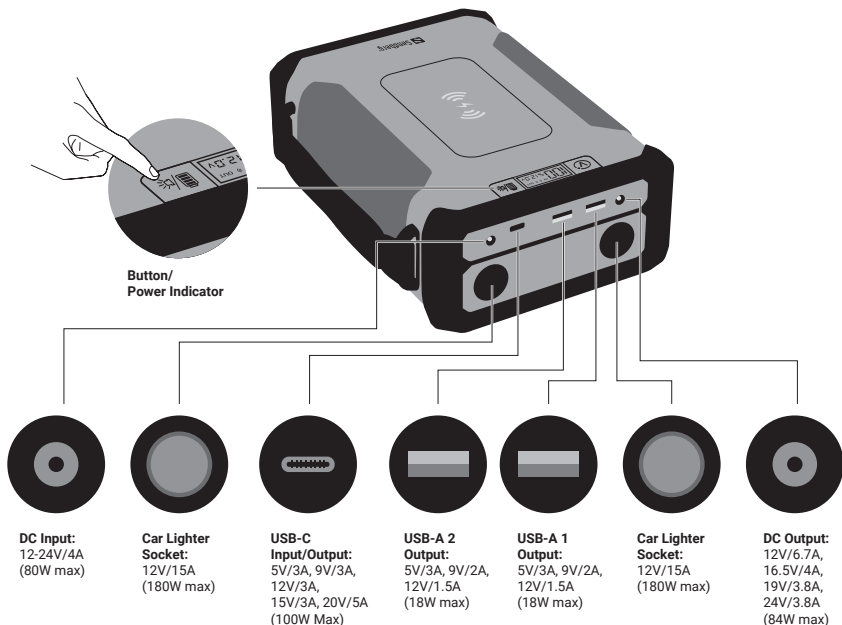

## Charge the powerbank

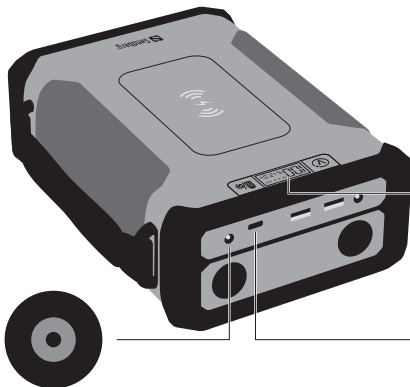

Charging indicator



**DC Input:**  
18-24V/4A (96W max)

**USB-C Input:**  
PD

### DC/PD Input



Solar Panel  
Charger



Wall  
Charger

## Charge mobile devices (USB and USB-C Output)

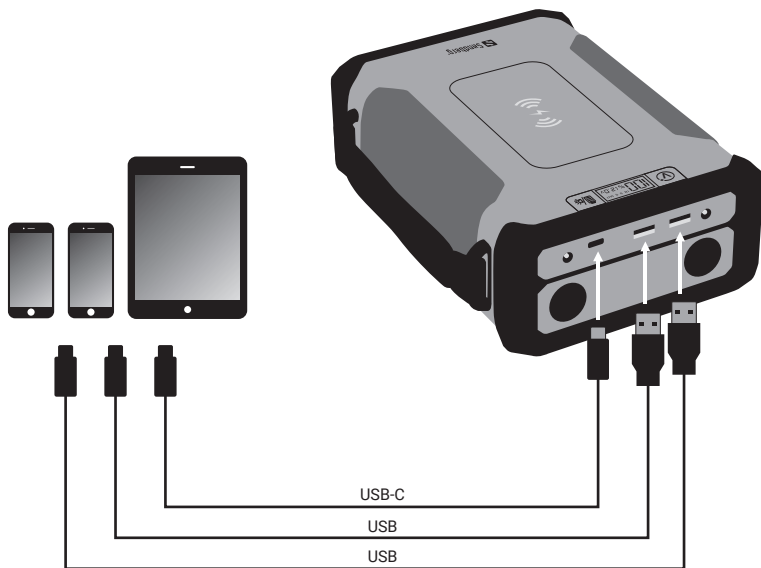

## Charge equipment (Car Lighter Socket)

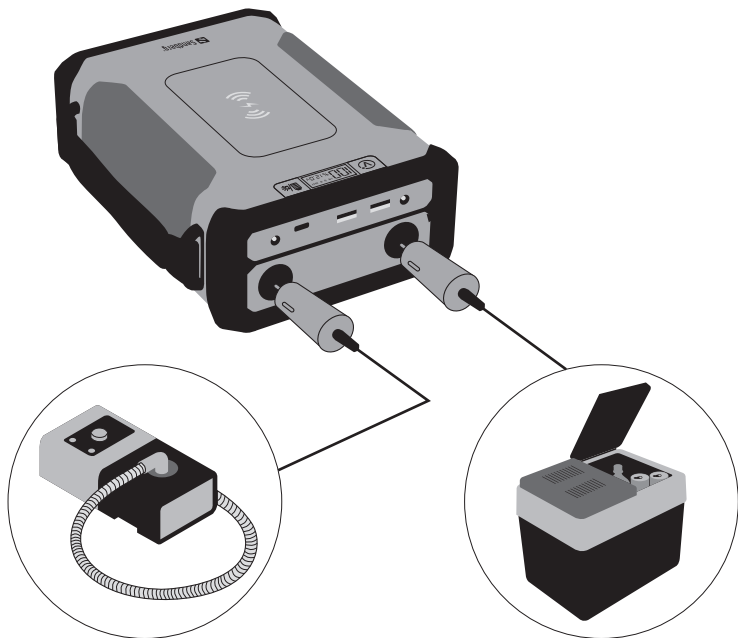

## Charge laptop (DC or USB-C Output)

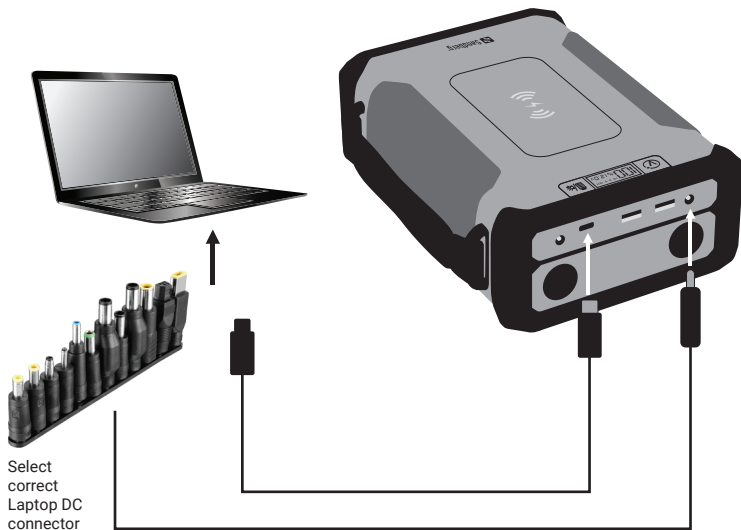

## Charging a laptop with DC cable - important note

1. Choose correct tip to fit the DC port of your laptop.
2. Set the correct voltage on the power bank:  
Keep long press on the button until display is flashing.

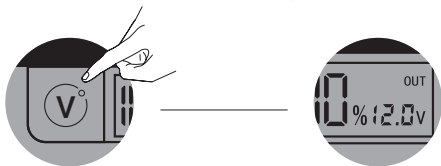

Click button short to step between Voltage 12V/16.5V/20V/24V.

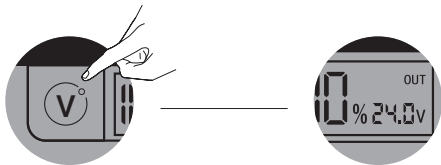

3. Connect the laptop, charge will start.
4. After disconnecting the laptop, you need to set the Voltage next time.  
**For safety it will always start the cycle at lowest setting 12V.**

**NOTE:** If you are in doubt on what DC-Voltage to choose, have a look at the label on the AC charger for the laptop.



Wireless charger

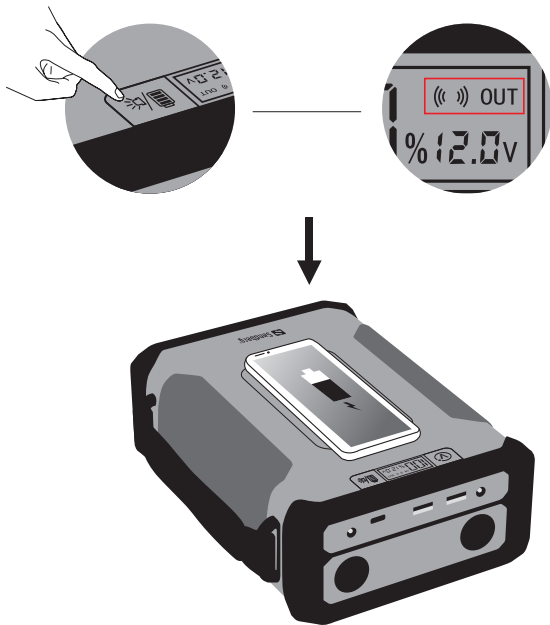

## Lamp

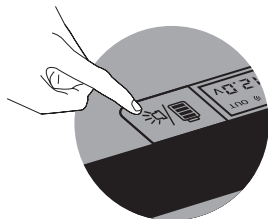

1. Long press

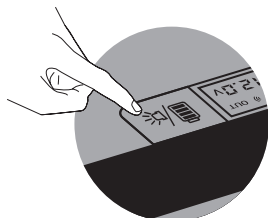

2. Long press



## Lamp

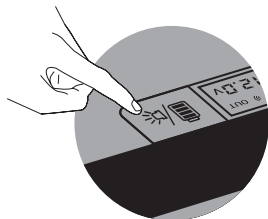

1. Press twice

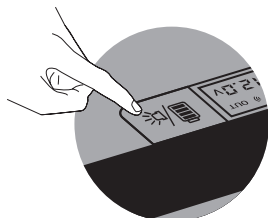
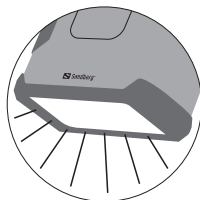

2. Press twice



## Warranty

There is a five-year warranty on your Sandberg product.  
Please read the warranty terms and register your new Sandberg product at [www.sandberg.world/warranty](http://www.sandberg.world/warranty)

**5**  
Years  
Warranty



Item no. 420-78

### Survivor Powerbank 8in1 96000

Battery capacity: 3.2V/96000 mAh/307.2 Wh      Product weight: 3030g

Battery pack capacity: 12.8V/24000 mAh/307.2 Wh

Battery type: Lifepo4 battery cell (32700)

1 x DC-port input: 12-24V/4A (80W max)

1 x DC-port output: 12V/6.7A, 16.5V/4A, 19V/3.8A, 24V/3.8A (84W max)

2 x USB-A QC output: 5V/3A, 9V/2A, 12V/1.5A (18W max)

1 x USB-C PD in/out: 5V/3A, 9V/3A, 12V/3A, 15V/3A, 20V/5A (100W Max)

2 x Car Lighter Socket: 12V/15A (180W max)

1 x Wireless charger: 15W (max)

[www.sandberg.world](http://www.sandberg.world)    [info@sandberg.world](mailto:info@sandberg.world)

Sandberg A/S  
Bregnerødvej 133D,  
3460 Birkerød, Denmark



#### PLEASE READ

This battery stays on in DC mode to ensure constant power.  
When not in use, hold the power button for 3 seconds to turn it off.  
If left on, the battery may slowly drain. Then recharge it when needed.

**NOTE:** For optimal battery performance, we recommend fully discharging and recharging the powerbank at least once every three months.

