

 Sandberg®

**ACTIVE** 

# Survivor Torch for AAA battery

Quick guide

421-07



International:

<https://sandberg.world/mt/manual/421-07>



Double  
Quality  
Tested

[www.sandberg.world](http://www.sandberg.world)

**Overview**

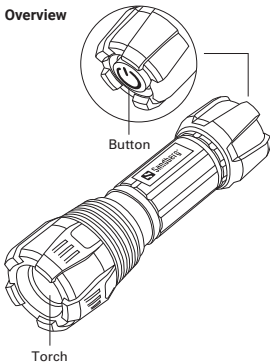

**Before use:**

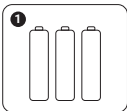

3 x AAA Battery  
(not included)

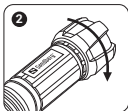

Unscrew the cap  
on the bottom of Torch.

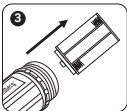

Take the battery  
case out.

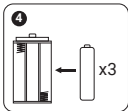

Insert 3 x AAA batteries  
into the battery case and  
check correct polarization.

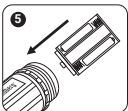

Put the battery case back into the torch.

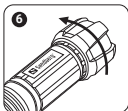

Screw the cap on the bottom of Torch.

## Torch

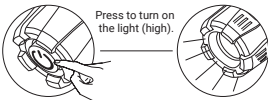

Press to turn on the light (high).

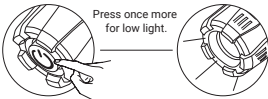

Press once more for low light.

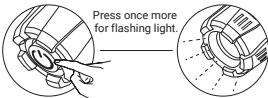

Press once more for flashing light.

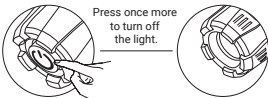

Press once more to turn off the light.

**Support**

<http://helpdesk.sandberg.world>

## Warranty

There is a five-year warranty on your Sandberg product. Please read the warranty terms and register your new Sandberg product at [www.sandberg.world/warranty](http://www.sandberg.world/warranty)

**5**  
Years  
Warranty

### Survivor Torch for AAA battery

Item no. 421-07      Made in China

Sandberg A/S, Bregnerødvej 133D,  
3460 Birkerød, Denmark

[www.sandberg.world](http://www.sandberg.world)



For information on handling electronic waste,  
see [www.sandberg.world/weee](http://www.sandberg.world/weee)

