



# Survivor Powerbank 100W 40000

Quick guide

421-14



## Survivor Powerbank 100W 40000

Item no. 421-14

Capacity: 40000 mAh / 154Wh / 3.85V (UN3480)

Input USB-C 1: 5V/3A, 9V/3A, 12V/3A, 15V/3A, 20V/3.25A (65W Max)

Output USB-C 1: 5V/3A, 9V/3A, 12V/3A, 15V/3A, 20V/5A (100W Max)

Output USB-C 2: 5V/3A, 9V/2.22A, 12V/1.67A (20W Max)

Output USB-A: QC 3.0 5V/3A, 9V/2A, 10V/2.25A, 12V/1.5A (22.5W Max)

USB-C1+USB-C2 Output: 65W+20W = 85W

USB-C1+USB-A Output: 65W+22.5W = 87.5W

USB-C1+(USB-C2+USB-A) Output: 65W+15W = 80W

Product weight: 809g

Sandberg A/S [www.sandberg.world](http://www.sandberg.world)  
Bregnerødvej 133D,  
3460 Birkerød, Denmark Made in China



**NOTE:** For optimal battery performance, we recommend fully discharging and recharging the power bank at least once every three months.



Double  
Quality  
Tested

5

Years  
Warranty

## Warranty

There is a five-year warranty on your Sandberg product. Please read the warranty terms and register your new Sandberg product at [www.sandberg.world/warranty](http://www.sandberg.world/warranty)

[www.sandberg.world](http://www.sandberg.world)

Support: <http://helpdesk.sandberg.world>



For information on handling electronic waste, see [www.sandberg.world/weee](http://www.sandberg.world/weee)

## Charge Powerbank

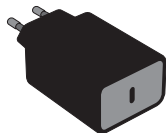

USB-C charger



USB-C

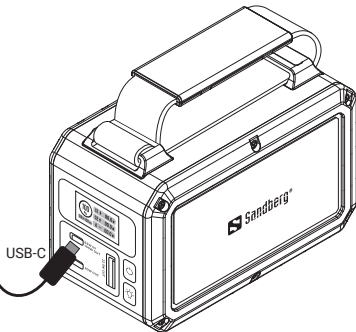

USB-C

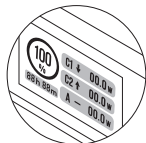

Charging status display

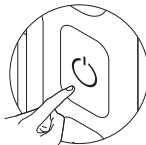

Click the button to check the capacity of Powerbank

### Smart display

The powerbank is charging itself.

Present power on USB-C 1

Remaining capacity in %

100 %

C1 00.0 w

C2 00.0 w

Present power on USB-C 2

Remaining capacity in time

88 h 88 m

A 00.0 w

Present power on USB-A

The powerbank is charging your device.

## Charge devices

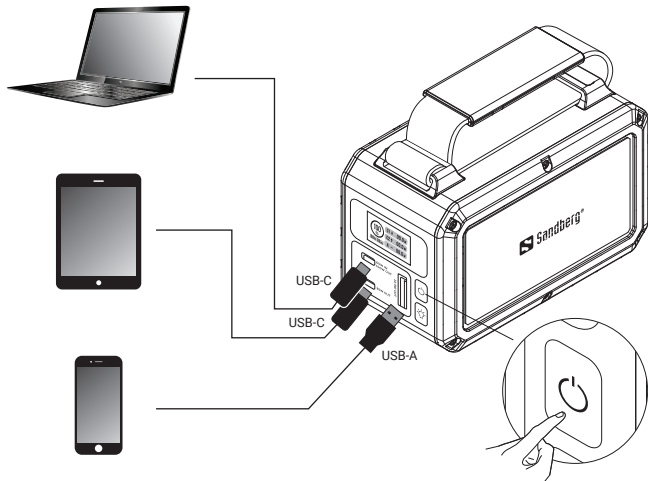

Example of use

## Flashlight procedure

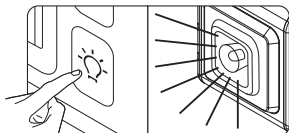

Press for the highest light intensity.

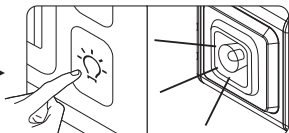

Press once more for the lowest light intensity.

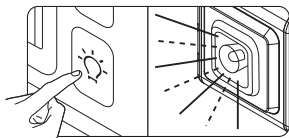

Press once more for SOS.

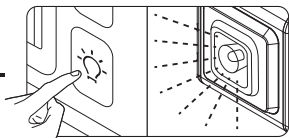

Press once more for caution light.

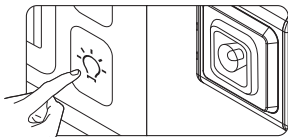

Long press to turn off the light.